

## 80ZYT / 46WJ15N WORM GEAR DC MOTOR

● **WORM GEAR REDUCER SPECIFICATIONS**

Reduction Ratio: 50:1 standard; 10, 15, 26, 36, 59 Optional.

● **PM DC MOTOR SPECIFICATIONS**

Model	Rated Voltage	No Load		Rated(额定)						Motor Length
		Speed	Current	Speed	Current	Torque		Power	Eff.	
	Vdc	RPM	Amp	RPM	Amp	oz-in	mNm	W	%	mm
80ZYT122-12-33	12	3300	2.1	2700	12	38	268	76	52.7	122
80ZYT122-12-49	12	4900	2.5	4000	17.5	38	268	112	53.5	122
80ZYT122-22-52	24	5200	1.5	4600	10	38	268	129	53.9	122

● **WORM GEARMOTOR SPECIFICATIONS:**

$Y[in-lb]=8.85075 * X[Nm]$

Motor Model	Reduction Ratio	10	15	26	36	50	59
		Efficiency %	80	76	73	70	57
80ZYT122-12-33	No-load speed (RPM)	330	220	138	87	66.0	44.0
	Rated speed (RPM)	270	180	113	71	54.0	36.0
	Rated load (N.m)	2.1	3.1	4.7	7.1	7.6	8.4
80ZYT122-12-49	No-load speed (RPM)	490	327	204	129	98.0	65.3
	Rated speed (RPM)	400	267	167	105	80.0	53.3
	Rated load (N.m)	2.1	3.1	4.7	7.1	7.6	8.4
80ZYT122-24-52	Rated speed (RPM)	460	307	192	121	92.0	61.3
	Rated load (N.m)	2.1	3.1	4.7	7.1	7.6	8.4

● **DIMENSIONS**

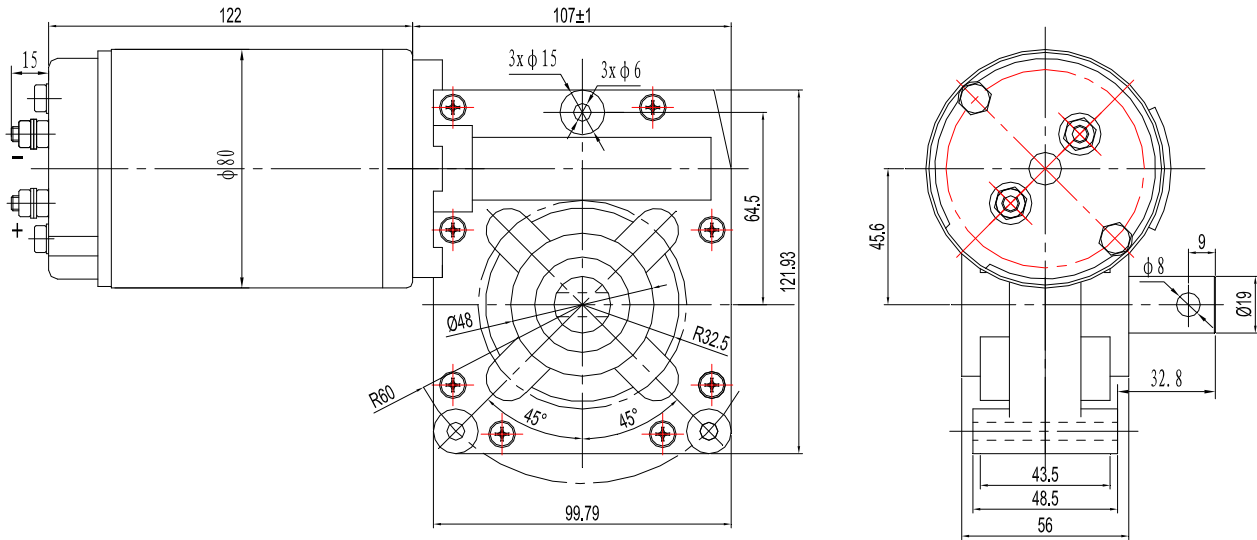

● **Production Number Code for Worm Gear Reducer**

