

22PA/20BYG PLANET GEAR STEPPER MOTOR

- Housing Material: Metal
- Backlash at No-Load: $\leq 1^\circ$
- Bearing at Output: Ball or Sleeve
- Permissible Overhung Load: $\leq 2.5\text{kg}$
- Permissible Thrust Load: $\leq 0.5\text{kg}$
- Max. Radial Play: $\leq 0.05\text{mm}$
- Max. Thrust Play: $\leq 0.3\text{mm}$

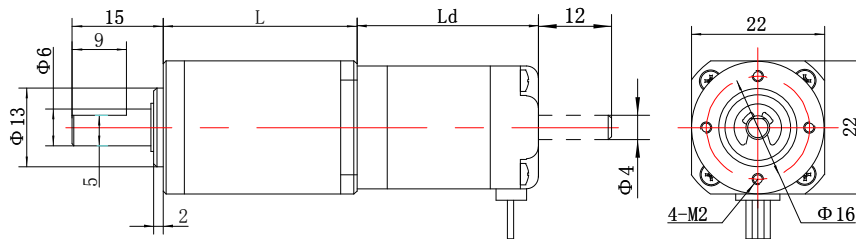

● Mechanical Dimensions



● Gear Box Data

Reduction Ratio	X:1	4	4.75	16	19	22.56	64	76	90.25	107.2
Number of gear trains	#	1	1	2	2	2	3	3	3	3
Max Permissible Torque	kg.cm	5	5	7	7	7	9	9	9	9
Moment Permissible Torque	kg.cm	10	10	15	15	15	20	20	20	20
Gear Box Length	mm	20.5	20.5	25.7	25.7	25.7	30.95	30.95	30.95	30.95

● Motor specifications

Model	Step Angle	Length (Ld)	Phase Voltage	Phase Current	Phase Resistance	Phase Inductance	Holding Torque	Lead Wire
	$^\circ$	mm	V	A	Ω	mH	g.cm	#
20BYG28-020-4A/B	1.8	28	4.8	0.2	24	8	160	4
20BYG30-050-6A/B	1.8	30	5.75	0.5	11.5	1.7	180	6
20BYG33-060-4A/B	1.8	33	3.9	0.6	6.5	2.2	200	4
20BYG38-060-4A/B	1.8	38	6	0.6	10	5.5	400	4

Replace □ with A = single shaft; replace □ with B = double shaft

Product Code:

22	PA	16	G	/	20	BYG	28	-	020	-	4	A
Size	Type	Ratio	Bearing		Size	Type	Length		Current		# leads	Shaft
22mm	Planetary	16:1	Ball		20mm	Hybrid	28mm		0.2A		4	single