

1.8° Size 14 Hybrid Motors

- General Specification for Hybrid Step Motors

Item	Specifications
Step Angle Accuracy	± 5% (full step, no load)
Resistance Accuracy	± 10%
Inductance Accuracy	± 20%
Temperature Rise	80°C Max. (rated current, 2 phase on)
Ambient Temperature	- 10°C ~ +50°C
Insulation Resistance	100 MΩ Min., 500 VDC
Dielectric Strength	500 VAC for one minute
Shaft Radial Play	0.06 Max. (450 g-load)
Shaft Axial Play	0.08 Max. (450 g-load)



- Size 14 Stepping Motor Specifications

Model No.		Rated Voltage	Per Phase			Holding Torque		# of Leads	Rotor Inertia	Weight
Single Shaft	Double Shaft		Current	Resistance	Inductance	Oz-in	Kg-cm			
		V	A	Ω	MH			g-cm ²	Kg	
14H100-025-6A	14H100-025-6B	12	0.25	48	13	5	0.36	6	10	0.09
14H100-048-4A	14H100-048-4B	6.3	0.48	13	4.8	6.94	0.5	4	10	0.09
14H100-080-4A	14H100-080-4B	3.8	0.8	4.8	3	6.94	0.5		10	0.09
14H100-132-4A	14H100-132-4B	2.3	1.32	1.75	1.2	6.94	0.5		10	0.09
14H110-032-6A	14H110-032-6B	14	0.32	44	19	9.71	0.7	6	12	0.12
14H110-040-6A	14H110-040-6B	11.2	0.4	28	12	9.71	0.7		12	0.12
14H110-047-4A	14H110-047-4B	9.47	0.47	20	19	13.88	1	4	12	0.12
14H130-019-6A	14H130-019-6B	24	0.19	126	90	12.91	0.93	6	14	0.16
14H130-043-6A	14H130-043-6B	10.75	0.43	25	16	12.91	0.93		14	0.16
14H130-050-4A	14H130-050-4B	9.25	0.5	18.5	26	18.04	1.3	4	14	0.16

- Motor Dimensions

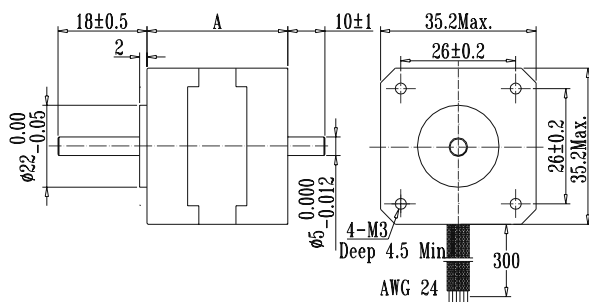

- Wiring Diagram

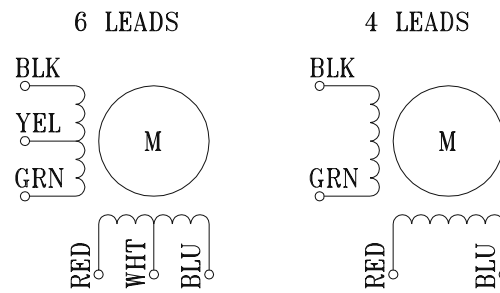

Model #	A	
	Inches	mm
14H100-xx	1	26
14H110-xx	1.1	28
14H130-xx	1.3	34

- Motor modification options

Motor : Special length, Windings Bearings, & Threads

Shaft : Flat, Pinion, Keyway, Length

Lead wire : Type, Color, Length, Connector Installation