

42BLY-Brushless DC Motor:

- General Specifications:**

Winding connection	STAR
Sensor position	120°
Insulation Class	B
Ambient temperature	-20°C~+50°C
Insulation resistance	100MΩ Min.500V DC
Dielectric strength	500V AC 1minute

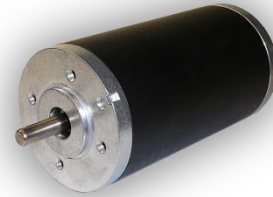

- Electrical Specifications**

Model	SEI	42BLY42-2430	42BLY60-2430	42BLY78-2430
	Factory	42BLY01	42BLY02	42BLY03
Nominal voltage	Vdc	24	24	24
Rated speed	RPM	3000	3000	3000
Rated Torque	N.m	0.035	0.07	0.13
Rated Current	Amps	0.9	2.1	3
Output Power	Watts	11	22	33
Peak Torque	N.m	0.11	0.21	0.39
Peak Current	Amps	2.7	6.3	9
Torque constant	N.m/A	0.035	0.035	0.036
Back EMF	V/krpm	3.37	3.37	3.38
Rotor inertia	g·cm ²	25	35	45
Body Length (L)	mm	42	60	78
Mass	Kg	0.35	0.5	0.8
Number of Poles & Phases		4 poles / 3 phases		

- Mechanical Dimensions(外形图)**

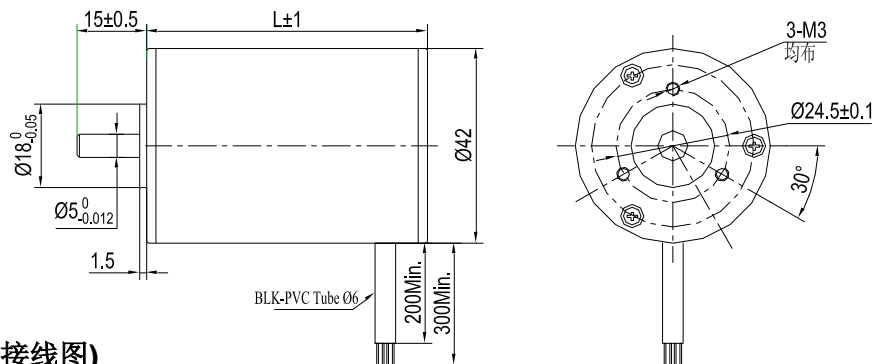

- Wiring Diagram(接线图)**

