

# 60x95 60JR95-50K - SPUR GEARHEAD (正齿轮箱) w/ 42ZYT PM DC MOTOR (永磁直流马达)



## ● GEARHEAD SPECIFICATIONS

Gear Ratio	Stage	Eff.	Rated Load	Max. Load
減速比	级数	效率	额定负载	最大负载
1:X	#	%	Kg.cm	Kg.cm
37 - 95	3	73	30	90
151 - 400	4	66	40	120
624 - 1166	5	59	50	150

## ● DIMENSIONS

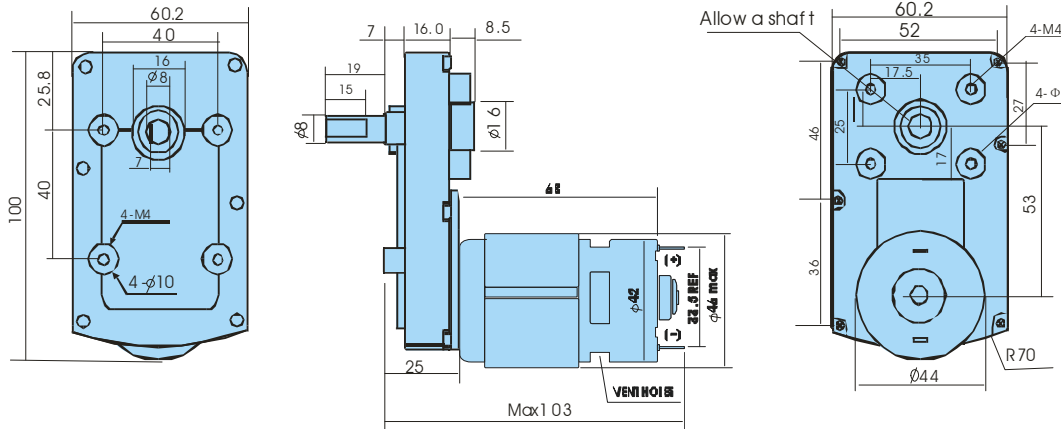

## ● MOTOR SPECIFICATIONS

Model	Rated	No-load		Rated				Stall	Motor	
	Voltage	Current	Speed	Current	Speed	Torque	Power	Torque	Dia.	Length
	VDC	A	r/min	A	r/min	g.cm	W	g.cm	mm	mm
42ZYT67-12-25	12	0.2	2500	0.9	1850	300	5.7	1.2	42.2	67
42ZYT67-12-38	12	0.25	3800	1.8	2900	375	11.2	1.6	42.2	67
42ZYT67-12-50	12	0.55	5000	2.94	4200	460	19.8	2.8	42.2	67
42ZYT67-24-25	24	0.15	2500	0.45	1850	300	5.7	1.2	42.2	67
42ZYT67-24-38	24	0.13	3800	0.9	2900	375	11.2	1.6	42.2	67
42ZYT67-24-50	24	0.25	5000	1.46	4200	460	19.8	2.8	42.2	67

## ● GEAR MOTOR SPECIFICATIONS: 60JR95-50KxxxG/Motor model Y(IN-LB) = 0.867313\*X(Kg.cm)

Volt.	Speed	Gear Ratio	37	67	95	151	196	277	400	624	1166
		Efficiency %	73	73	73	66	66	66	66	59	59
12 Vdc	2500	Rated speed (RPM)	50	28	19	12	9.4	6.7	4.6	3.0	1.6
		Rated load (Kg.cm)	8.10	14.7	20.8	29.9	38.8	40	40	50	50
	3800	Rated speed (RPM)	78	43	31	19	14.8	10.5	7.3	4.6	2.5
		Rated load (Kg.cm)	10.1	18.3	26.0	37.4	40	40	40	40	50
	5000	Rated speed (RPM)	114	63	44	28	21.4	15.2	10.5	6.7	3.6
		Rated load (Kg.cm)	12.4	22.5	31.9	40	40	40	121.4	50	50
24 Vdc	2500	Rated speed (RPM)	50	28	19	12	9.4	6.7	4.6	3.0	1.6
		Rated load (Kg.cm)	8.10	14.7	20.8	29.9	38.8	40	40	50	50
	3800	Rated speed (RPM)	78	43	31	19	14.8	10.5	7.3	4.6	2.5
		Rated load (Kg.cm)	10.1	18.3	26.0	37.4	40	40	40	40	50
	5000	Rated speed (RPM)	114	63	44	28	21.4	15.2	10.5	6.7	3.6
		Rated load (Kg.cm)	12.4	22.5	31.9	40	40	40	40	40	50