

0.9° Size 17 High Torque High Resolution

• **General Specification for Hybrid Step Motors**

Item	Specifications
Step Angle Accuracy	± 5% (full step, no load)
Resistance Accuracy	± 10%
Inductance Accuracy	± 20%
Temperature Rise	80°C Max. (rated current, 2 phase on)
Ambient Temperature	- 10°C ~ +50°C
Insulation Resistance	100 MΩ Min., 500 VDC
Dielectric Strength	500 VAC for one minute
Shaft Radial Play	0.06 Max. (450 g-load)
Shaft Axial Play	0.08 Max. (450 g-load)



• **Size 17 High Torque High Resolution Motor Specifications**

Model No.		Rated Voltage	Per Phase			Holding Torque		# of Leads	Rotor Inertia	Weight
Single Shaft	Double Shaft		Current	Resistance	Inductance	Oz-in	Kg-cm			
17H100HM-091-4A	17H100HM-091-4B	3	0.91	3.3	8	21.5	1.6	4	28	0.19
17H100HM-065-6A	17H100HM-065-6B	4.29	0.65	6.6	7.5	16.0	1.15	6		
17H130HM-095-6A	17H130HM-095-6B	4	0.95	4.2	2.5	22	1.58	6	35	0.22
17H130HM-060-6A	17H130HM-060-6B	6	0.6	10	6.1					
17H130HM-031-6A	17H130HM-031-6B	12	0.31	38.5	21					
17H130HM-133-4A	17H130HM-133-4B	2.8	1.33	2.1	2.5	30	2.2	4	54	0.28
17H150HM-120-6A	17H150HM-120-6B	4	1.2	3.3	3.2	36	2.59	6		
17H150HM-080-6A	17H150HM-080-6B	6	0.8	7.5	6.7					
17H150HM-040-6A	17H150HM-040-6B	12	0.4	30	30					
17H150HM-168-4A	17H150HM-168-4B	2.8	1.68	1.65	3.2	50	3.6	4	68	0.35
17H185HM-120-6A	17H185HM-120-6B	4	1.2	3.3	2.8	44	3.17	6		
17H185HM-080-6A	17H185HM-080-6B	6	0.8	7.5	6.3					
17H185HM-040-6A	17H185HM-040-6B	12	0.4	30	25					
17H185HM-168-4A	17H185HM-168-4B	2.8	1.68	1.65	2.8	62	4.4	4		

• **Dimensions:**

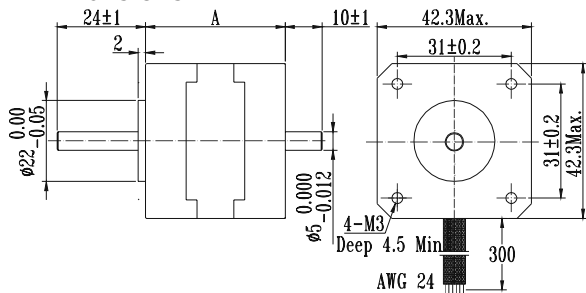

Model #	A	
	Inches	mm
17H100	1.00	25
17H130	1.30	33
17H150	1.50	38
17H185	1.85	47

• **Wiring Diagram**

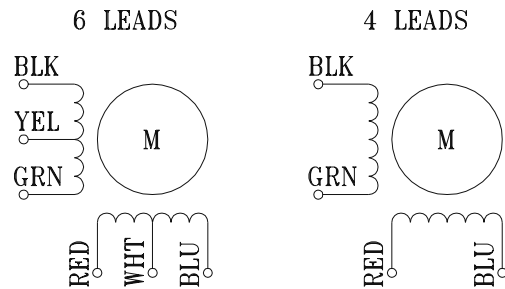

• **Motor modification options**

Motor : Special length, Windings Bearings, & Threads

Shaft : Flat, Pinion, Keyway, Length

Lead wire: Type, Color, Length, Connector Installation